

Diversity on Display: Who's on the Wall at NGA?

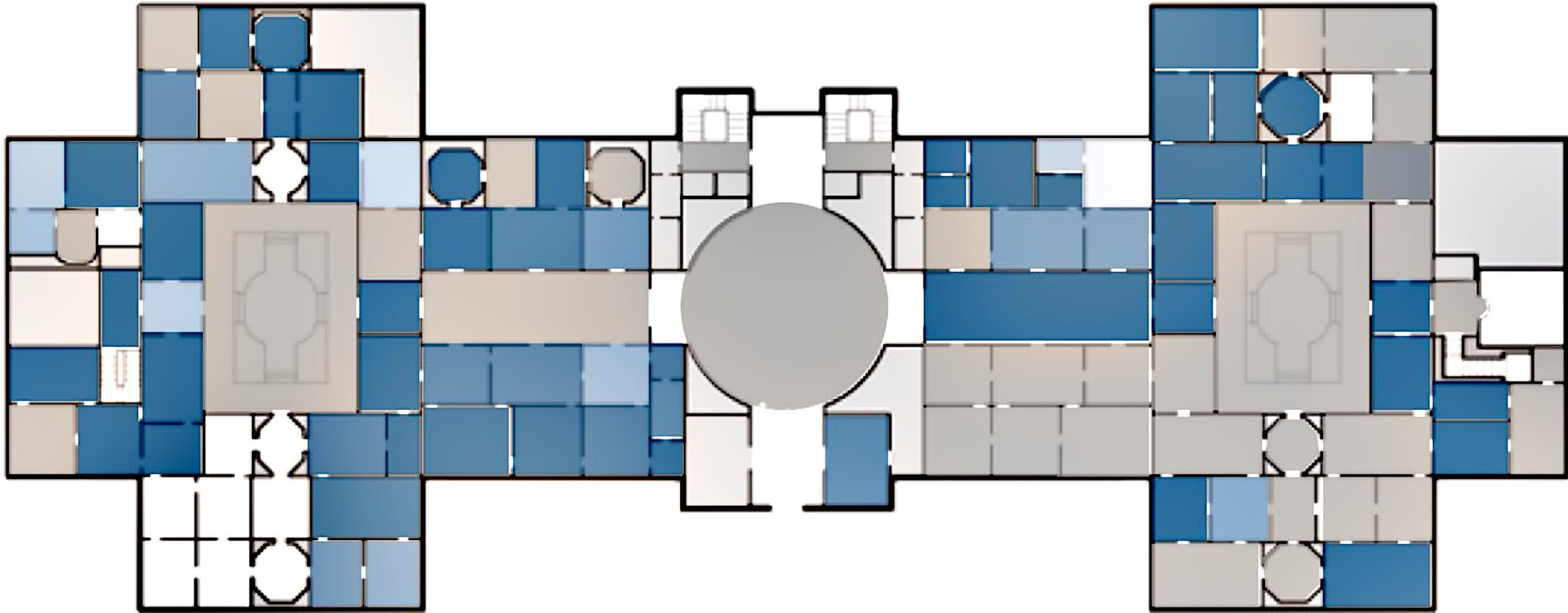

Brianna Heggeseth
Prof. of Statistics
Macalester College

Bernhard Klingenberg
Prof. of Statistics
New College of Florida

Steven Nelson
Prof. of Art History
UCLA

Chad Topaz
Prof. of Mathematics
Williams College

Diversity of Artists in Major U.S. Museums

C.M. Topaz, B. Klingenberg, D. Turek, B. Heggeseth, P. Harris, J.C. Blackwood, C.O. Chavoya, S. Nelson, K.M. Murphy. [PLOS One open access](#) (2019).

Museum	% Women	% White	% Black/Af. Am.	% Hisp./Lat.	% Asian	% Other
Detroit	7.4	94.7	1.6	0.4	2.8	0.6
Met	7.3	88.9	0.2	1.5	8.1	1.3
MFA Boston	8.2	79.9	1.1	2.1	16.1	0.8
NGA	10.4	97.4	0.0	0.6	1.3	0.6
Philadelphia	8.8	87.8	1.1	2.4	8.3	0.4
Overall (18 museums)	12.6	85.4	1.2	2.8	9.0	1.5

QSIDE: Institute for the Quantitative Study of Inclusion, Diversity, and Equity
<http://www.qsideinstitute.org>

NGA Collection Overview (111,000 objects)

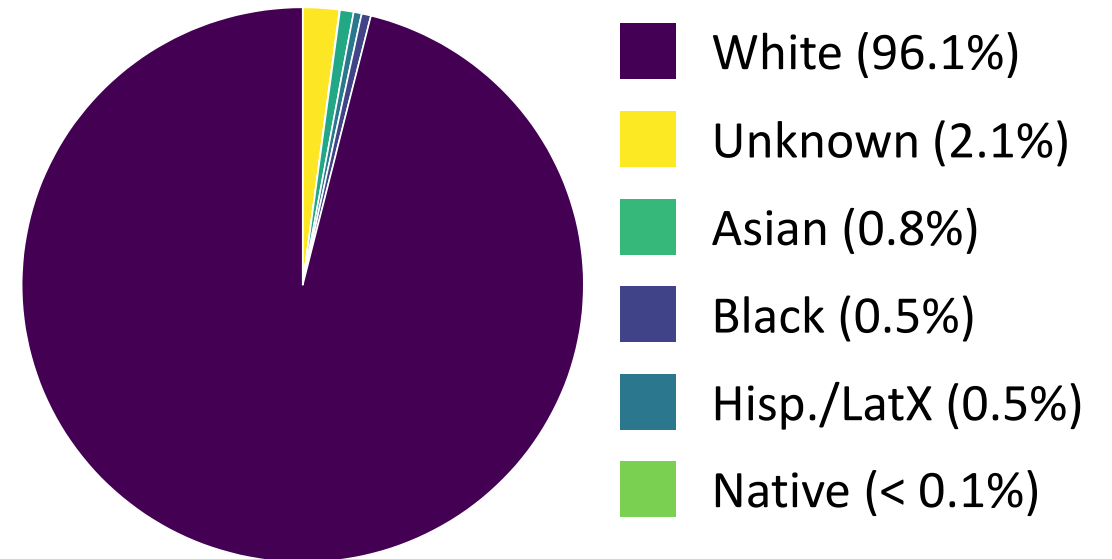
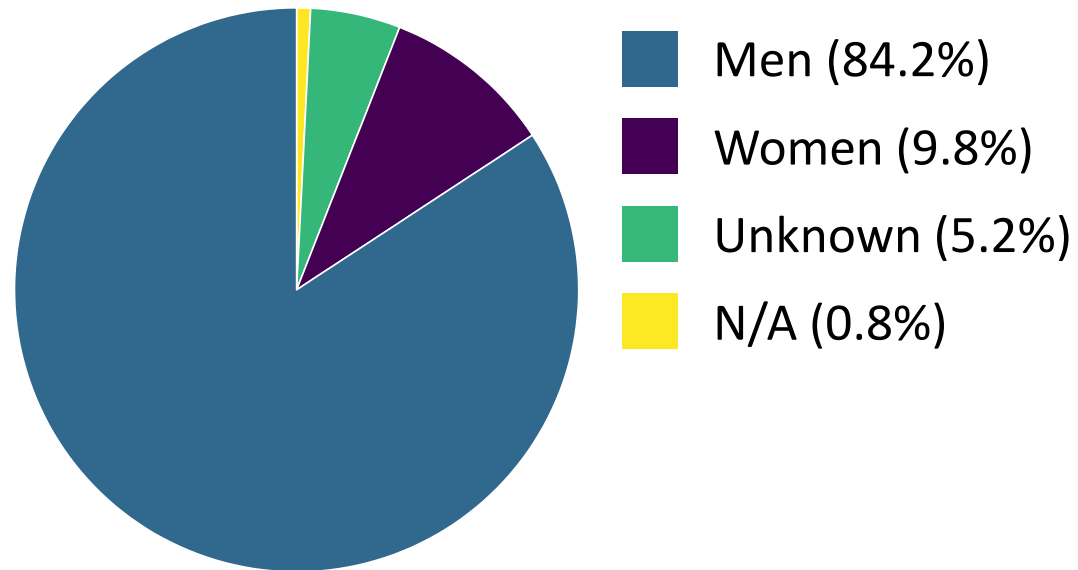

- [Union List of Artists Names \(ULAN\)](#) - J. Paul Getty Trust
- [R gender package](#)
- Art History Expertise
- U.S. Census Bureau Race/Ethnicity definitions

Whose perspectives do visitors experience?

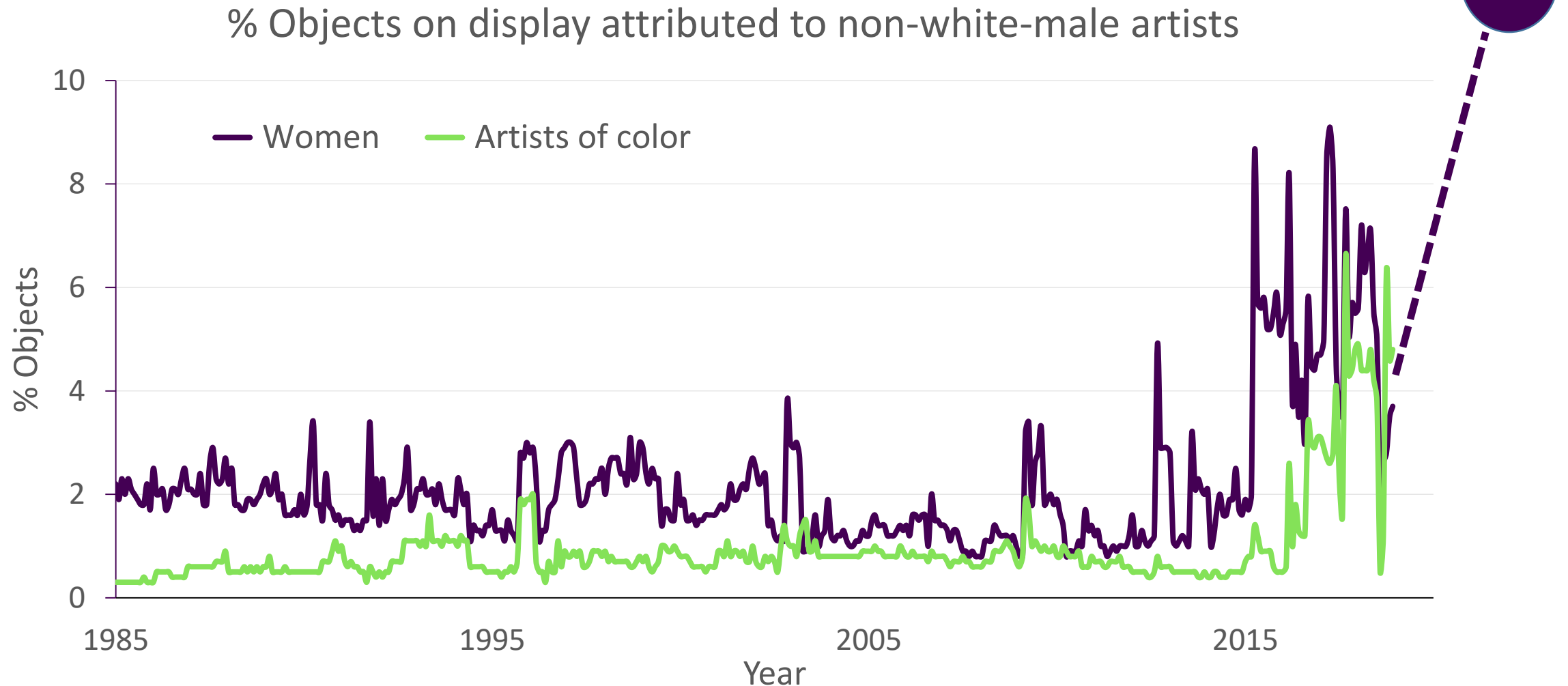

Diversity on Display (<https://bheggeseth.shinyapps.io/DiversityOnDisplay>)

Diversity on Display: Who's on the Wall at NGA?

Created by [Brianna Heggeseth](#), [Bernhard Klingenberg](#), [Steven Nelson](#), [Chad Topaz](#)

Description: These visualizations show the artist gender identity, race/ethnicity, and geographical distribution of the NGA collection objects that are on public view over time on a chosen museum floor. Collection data and floor maps courtesy of the National Gallery of Art.

Select Distribution of Interest:

Gender

Spatial View Overall View

Select a Building & Floor of NGA: West Building - Main

Select Date: Jan 1985 Jun 2018

Select Gender Identity of Interest (for Floor Map): Men

Jun 2018

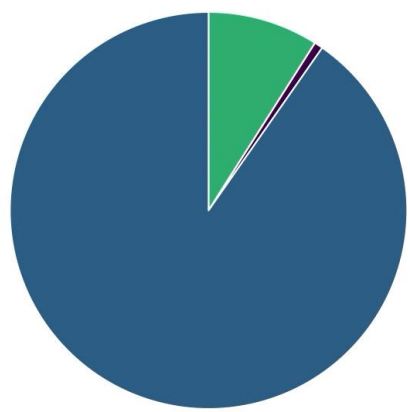

Artist Gender Identity

- Men
- Women
- Unknown
- N/A

Jun 2018

Percentage Men 0 25 50 75 100

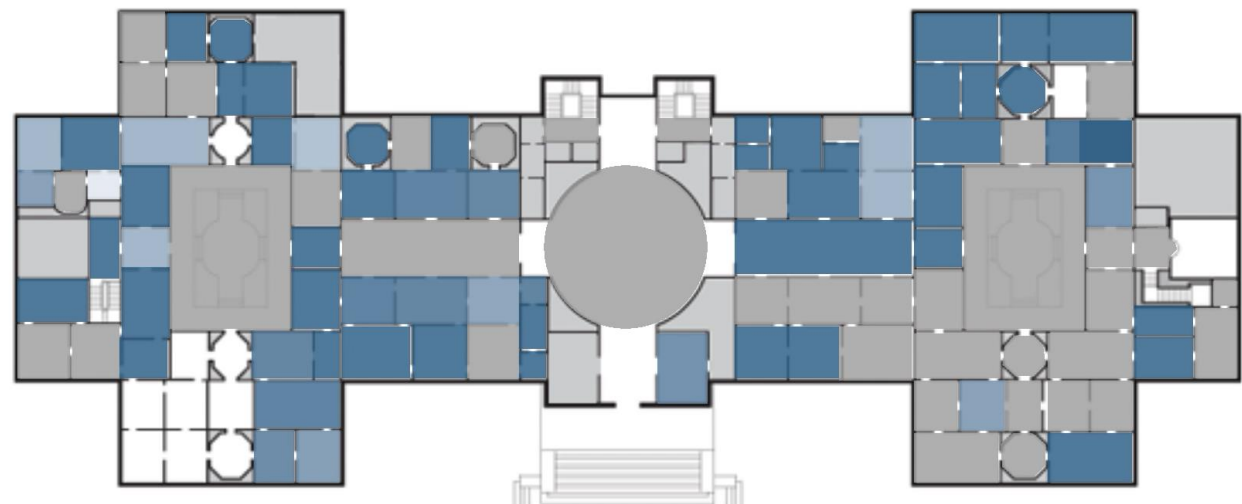

Data transparency, accuracy, and availability



[Yinka Shonibare](#)

British, born 1962

Girl on Globe 2

2011

fiberglass mannequin, Dutch wax printed cotton, and globe

overall (mannequin): 100.01 × 74.93 × 81.92 cm (39 3/8 × 29 1/2 × 32 1/4 in.)

overall (diameter of globe): 80.01 cm (31 1/2 in.)

[Corcoran Collection \(Museum Purchase, by exchange: William A. Clark Collection\)](#)

2015.19.3962

Not on View

[share](#)

So what?

- Benchmarks for diversity/inclusion initiatives
- Provides foundation for cross-departmental collaboration
- Enhances art historical/museum studies research
- Prompts reflection on past curatorial choices
- Enables what-if scenarios
- Suggests **data curation as powerful complement to art curation**

Diversity on Display

<https://bheggeseth.shinyapps.io/DiversityOnDisplay>